

GRAPHIC SIGN

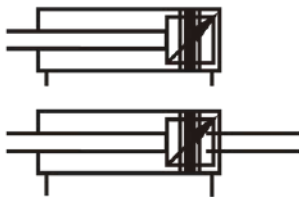

ORDERING CODE

Series Code (SC)	Cylinder Bore (50)	Stroke (50)	Magnet Code (S)	Fixed Type ()
SC : Standard Double Action (Tie-Rod Type) SCD : Double Shaft Double Action (Tie Rod Type) SU : Standard Double Action (Micky Mouse Type) SUD : Double Shaft Double Action (Micky Mouse Type)	32mm-250mm		Blank : without Magnet S : with Magnet	Blank : Normal Type LB : Front & Back Fixed Type FA : Front Cover Fixed Type (Front flange type) FB : Back Cover Fixed Type (Back flange type) CA : Back Cover Fixed Type (Single Earring) CB : Back Cover Fixed Type (Double Earring) TC : Central Trunnion Type TC-M : Central Trunnion Type attaching foot seat

1 Piston Rod Nut	10 Wear Ring
2 Piston Rod	11 Barrel
3 Front Cover Seal ring	12 Buffering Barrel O-Ring
4 Bearing	13 Damping Adjustable Screw
5 Front Cover	14 Back Cover
6 Buffering O-Ring	15 Hex Socket Screw
7 Pipe Wall O-Ring	16 Tie Rod Nut
8 Piston O-Ring	17 Tie Rod
9 Piston	18 Piston Rod O-Ring

INTERNAL STRUCTURE

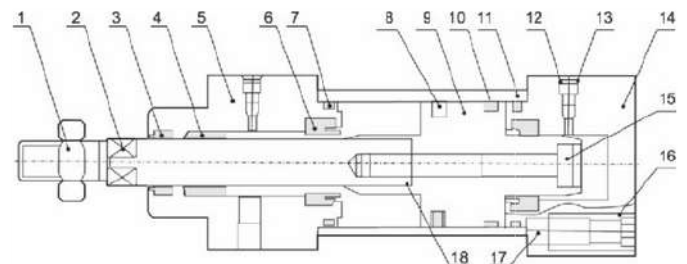

SPECIFICATION

Bore (mm)	32	40	50	63	80	100	125	160	200	250
Motion Pattern	Duble Action									
Working Medium	Air									
Fixed Type	Basic type FA type FB type CA type CB type LB type TC type TC-M type									
Operating Voltage Range	0.1~0.9kgf/cm2									
Ensured Pressure Resistance	1.35Mpa									
Operating Temperature Range	-5~70oC									
Operating Speed Range	300~800mm/s									
Buffer Type	Adjustable Buffer									
Buffer Stroke	24								32	
Port Size	G1/8"	G1/4"	G3/8"	G1/2"	G3/4"	G1"				

STROKE

Bore	Standard Stroke																			Buffer Stroke	
	25	50	75	80	100	125	160	175	200	250	300	350	400	450	500
32	25	50	75	80	100	125	160	175	200	250	300	350	400	450	500	1000
40	25	50	75	80	100	125	160	175	200	250	300	350	400	450	500	600	700	800	1200
50	25	50	75	80	100	125	160	175	200	250	300	350	400	450	500	600	700	800	900	1000	1200
63	25	50	75	80	100	125	160	175	200	250	300	350	400	450	500	600	700	800	900	1000	1500
80	25	50	75	80	100	125	160	175	200	250	300	350	400	450	500	600	700	800	900	1000	1500
100	25	50	75	80	100	125	160	175	200	250	300	350	400	450	500	600	700	800	900	1000	1500
125	25	50	75	80	100	125	160	175	200	250	300	350	400	450	500	600	700	800	900	1000	1500
160	25	50	75	80	100	125	160	175	200	250	300	350	400	450	500	600	700	800	900	1000	1500
200	25	50	75	80	100	125	160	175	200	250	300	350	400	450	500	600	700	800	900	1000	1500
250	25	50	75	80	100	125	160	175	200	250	300	350	400	450	500	600	700	800	900	1000	1500

OVERALL DIMENSION

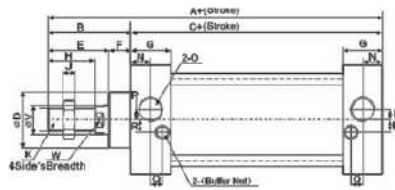

SC / SU

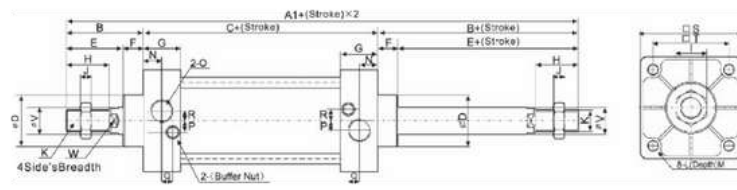

SCD / SUD

DIMENSION SHEET

Bore	32	40	50	63	80	100	125	160	200	Bore	32	40	50	63	80	100	125	160	200
A	140	142	150	153	182	188	239	291	272	L	M6 X 1	M6 X 1	M6 X 1	M8 X 1.25	M10 X 1.5	M10 X 1.5	M12 X 1.75	M16 X 2	M16 X 2
A1	187	191	207	210	257	263	330	412	409	M	9.5	9.5	9.5	9.5	11.5	11.5	21	25	25
B	47	49	57	57	75	75	104	121	132	N	13.7	13.5	13.5	13.5	16.5	16.5	16.5	26	22.5
C	93	93	93	96	107	108	136	162	140	O	G1/8"	G1/4"	G1/4"	G3/8"	G3/8"	G1/2"	G1/2"	G3/4"	G3/4"
D	28	32	36	36	47	47	56	62	75	P	3.5	6	8.5	7	10	11	/	/	/
E	32	34	42	42	54	54	71	92	117	Q	7.5	8.2	8.2	9.5	9.5	/	/	/	/
F	15	15	15	15	21	21	32	60	30	R	7	9	9	8.5	14	14	/	/	/
G	27.5	27.5	27.5	27.5	33	33	40	50	41	S	45	50	62	75	94	112	140	180	220
H	22	24	32	32	40	40	54	72	72	T	33	37	47	56	70	84	110	140	175
I	17	17	23	23	26	26	36	50	50	V	12	16	20	20	25	25	32	40	33
J	6	7	8	8	10	10	9	16	16	W	10	14	17	17	22	22	28	36	38
K	M10 X 1.25	M12 X 1.25	M16 X 1.5	M16 X 1.5	M20 X 1.5	M20 X 1.5	M27 X 2	M36 X 2	M36 X 2	Z	21	21	23	23	29	29	33	38	42

GRAPHIC SIGN



ORDERING CODE

Series Code (DNC)	Cylinder Bore (63)	Stroke (50)	Magnet Code (S)	Fixed Type ()
DNC : ISO6431 Standard Double Action Type DNCD : ISO6431 Standard Two Axis Double Action Type	32mm-125mm		Blank : without Magnet S : with Magnet	Blank : Normal Type LB : Front & Back Fixed Type FA : Front Cover Fixed Type (Front flange type) FB : Back Cover Fixed Type (Back flange type) CA : Back Cover Fixed Type (Single Earring) CB : Back Cover Fixed Type (Double Earring) SDB : Back cover fixed type

1 Piston Rod Nut	10 Magnet (Optional)
2 Piston Rod	11 Wear Ring
3 Front Cover Seal ring	12 Barrel
4 Bearing	13 Piston
5 Front Cover	14 Cushion Seal
6 Buffering O-Ring	15 Cushion Needle
7 O-Ring	16 Back Over
8 Piston rod O-Ring	17 Hex Socket Screw
9 Piston O-Ring	18 Profile Bolt

INTERNAL STRUCTURE

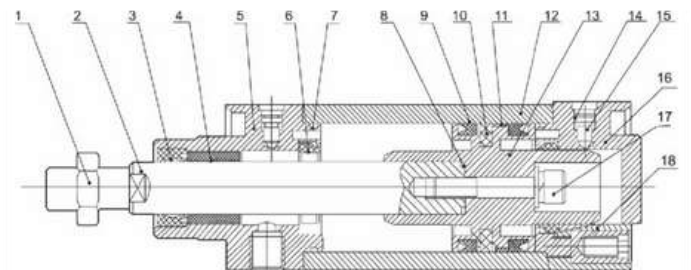

SPECIFICATION

Bore (mm)	32	40	50	63	80	100	125
Motion Pattern	Filtered Air						
Working Medium	Double Action						
Compression Pressure	1.5MPa						
Max. Operating Pressure	1.0MPa						
Min. Operating Pressure	0.1MPa						
Buffer	Air Buffer (Standard)						
Condition Temperature	-5~70C						
Operating Speed	50~800mm/s						
Port Size	G1/8"	G1/4"	G3/8"	G1/2"			

STROKE

Bore	Standard Stroke	Buffer Stroke	Stroke Range
32	25	20	
	40		
40	50		
	80		
50	100	22	
	125		
63	160		10 - 2000
	200		
80	250	32	
	320		
100	400		
	500		
125		35	

OVERALL DIMENSIONS

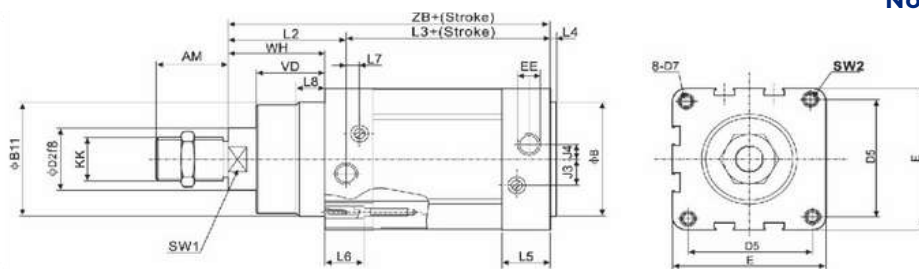

DIMENSION SHEET

Bore	AM	B	D2	D5	D7	E	EE(G)	J3	J4	KK	L2	L3	L4	L5	L6	L7	L8	Sw1	Sw2	VD	WH
32	22	30	12	32.5	M6	45	1/8	6	5.2	M10 X 1.25	41.6	62.8	4	26	16	3.3	10	10	6	12	26
40	24	35	16	38	M6	54	1/4	8	6	M12 X 1.25	44	77	4	29.6	16	3.6	10.5	13	6	20	30
50	32	40	20	46.5	M8	64	1/4	10	8.5	M16 X 1.5	51	78	4	30	17	5.1	11.5	17	8	27	37
63	32	45	20	56.5	M8	75	1/8	12.4	10	M16 X 1.5	54	87	4	35.6	17	6.6	15	17	8	27	37
80	40	45	25	72	M10	93	3/8	12.5	8	M20 X 1.5	62.4	95.2	4	35.9	17	10.5	15.7	22	10	34.7	46
100	40	55	25	89	M10	110	1/2	11.8	10	M20 X 1.5	69.8	100.4	4	39	17	8	19.2	22	10	38	51
125	54	60	32	110	M12	134	1/2	13	8	M27 X 2	83	124	6	44.7	22	14	20.5	28	12	46	65

Double Piston Rod Type DNC-D-S

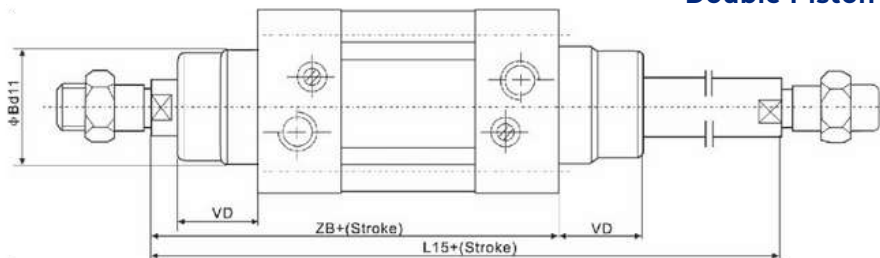

DIMENSION SHEET

Bore	32	40	50	63	80	100
B	30	35	40	45	45	55
L15	46	165	180	195	220	240
VD	16	20	27	27	34.7	38.2
28	120	135	143	158	174	189

GRAPHIC SIGN

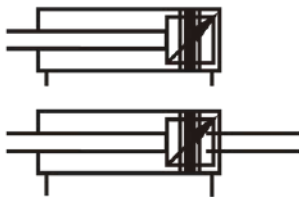

ORDERING CODE

Series Code (MAL)

MAL : Double Action Type
 MSAL : Single Extrusion Type
 MALD : Dual Double Action Type

Cylinder Bore (20)

16mm-40mm

Stroke (50)

Blank : without Magnet
 S:with Magnet

Magnet Code (S)

Fixed Type ()

Blank : Normal Type
 LB : Front & Back Fixed Type
 FA : Front Cover Fixed Type
 SDB : Back Cover Swinging Type

- | | |
|-------------------------|----------------------|
| 1 Piston Rod Nut | 9 Anti-crash Cushion |
| 2 Piston Rod | 10 Piston Rod O-Ring |
| 3 Front Cover Seal ring | 11 Piston O-Ring |
| 4 Oiled Bearing | 12 Piston |
| 5 Front Cover Nut | 13 Wear Ring |
| 6 Front Cover | 14 Back Cushion |
| 7 Pipe Wall O-Ring | 15 Hex Socket Screw |
| 8 Aluminum Tube | 16 Back Cover |

INTERNAL STRUCTURE

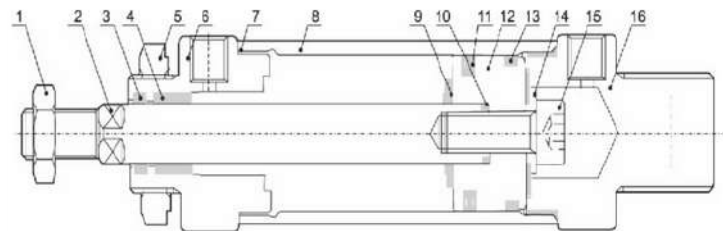

SPECIFICATION

Bore (mm)	16	20	25	32	40
Motion Pattern	Double Action or Single Action				
Working Medium	Air				
Fixed Type	Normal Type LB Type FA Type SDB Type				
Operating Voltage Range	0.1~0.9Mpa				
Ensured Pressure Resistance	1.35Mpa				
Operating Temperature Range	-5~70C				
Operating Speed Range	30~800mm/s				
Buffer Type Standard Type	Anti-Crash Cushion				
Buffer Type Damping Type	Adjustable Cushion				
Port Size	M5X0.8	G1/8"	G1/8"	G1/8"	G1/4"

STROKE

Bore	Standard Stroke															Max Stroke
	25	50	75	80	100	125	160	175	200	250	300	350	400	450	500	
16	25	50	75	80	100	125	160	175	200							300
20	25	50	75	80	100	125	160	175	200	250	300					300
25	25	50	75	80	100	125	160	175	200	250	300	350	400	450	500	300
32	25	50	75	80	100	125	160	175	200	250	300	350	400	450	500	300
40	25	50	75	80	100	125	160	175	200	250	300	350	400	450	500	300

OVERALL DIMENSION

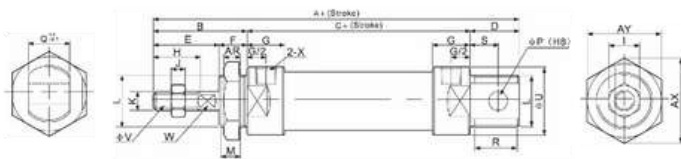
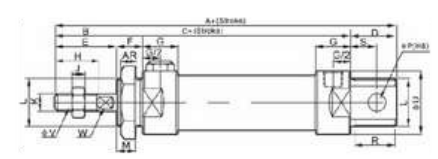
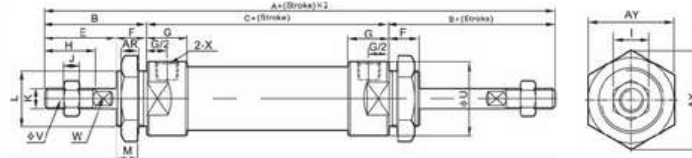
MAL

MSAL

MALD

DIMENSION SHEET

Bore	16	20	25	32	40	Bore	16	20	25	32	40
A	114	131	135	141	165	L	M16 X 1.5	M22 X 1.5	M22 X 1.5	M24 X 2.0	M30 X 2.0
A-MALD	...	150	158	158	184	M	14	10	1	12	12
B	38	40	44	44	45	P	6	8	8	10	12
C	60	70	70	70	92	Q	12	16	16	16	20
D	16	21	21	27	27	R	14	19	19	25	25
E	22	28	30	30	32	S	9	12	12	15	15
F	16	16	16	16	22	U	21	29	34	39.5	49.5
G	10	16	16	16	22	V	6	8	10	12	16
H	16	20	22	22	24	W	5	6	8	10	14
I	10	12	17	17	17	X	M5	G1/8"	G1/8"	G1/8"	G1/4"
J	5	6	6	6	7	AR	6	7	7	8	9
K	M6 X 1	M8 X 1.25	M10 X 1.25	M10 X 1.25	M12 X 1.25	AX	25	33	33	37	37
						AY	22	29	29	32	41

GRAPHIC SIGN



ORDERING CODE

Series Code (MS)	Cylinder Bore (20)	Stroke (50)	Magnet Code (S)	Fixed Type ()
MS : Double Action Type MSS : Single-Extrusion Type	8mm-25mm		Blank : without Magnet S:with Magnet	Blank : Normal Type LB : Front & Back Fixed Type FA : Front Cover Fixed Type SDB : Back Cover Swinging Type U : Back Cover Fixed Type

1 Piston Rod	9 Barrel
2 Piston Rod Nut	10 Piston Rod O-Ring
3 Front Cover Seal ring	11 Piston O-Ring
4 Bearing	12 Magnet (Optional)
5 Hexagon Screw	13 Wear Ring
6 Front Cover	14 Piston
7 Cushion Ring	15 Hex Socket Screw
8 O-Ring	16 Back Cover

INTERNAL STRUCTURE

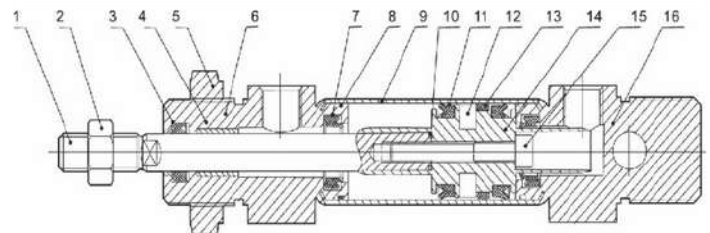

SPECIFICATION

Bore (mm)	8	10	12	16	20	25
Fluid	Air					
Motion Pattern	Double Action					
Ensured Pressure Resistance	15.3kgf/cm ² (1.5Mpa)					
Max. Pressure	10.2kgf/cm ² (1.0Mpa)					
Min. Pressure	0.5kgf/cm ² (0.05Mpa) 1kgf/cm ² (0.1Mpa)					
Environment & Fluid Temp	-10~+80oC (Internal Magnetic Install by Tach Strap : Type Max : 60oC)					
Piston Velocity	Rubber Buffer (Standard), Air Buffer (Option)					
Buffering	50~750mm/s					
Kinetic energy to Lerance (kgf/cm)	0.2	0.3	0.4	0.5	2.7	4
Port Size	M5X0.8				G1/8"	

STROKE

Bore	Standard Stroke												Max Stroke	
	10	25	40	50	80	100	125	160	200	250	300	350		
8	10	25	40	50	80	100	125	160	200					400
10	10	25	40	50	80	100	125	160	200					400
12	10	25	40	50	80	100	125	160	200					400
16	10	25	40	50	80	100	125	160	200					400
20	25	40	50	80	100	125	150	160	175	200	250	300		1000
25	25	40	50	80	100	125	150	160	175	200	250	300		1000

OVERALL DIMENSION

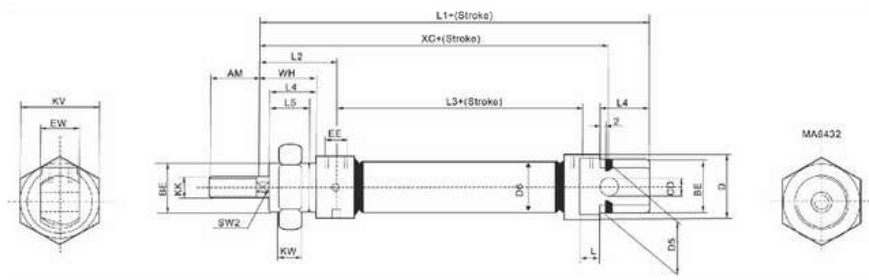

DIMENSION SHEET

Bore	8	10	12	16	20	25	KV	19	19	24	24	32	32
AM	12	12	16	16	20	22	KW	6	6	8	8	11	11
BE	M12 X 1.25	M16 X 1.25	M16 X 1.5	M16 X 1.5	M22 X 1.5	M22 x1.5	L	6	6	9	9	12	12
CD	4	4	6	6	8	8	L1	78	78	89	95	112	120
D	15	15	20	20	27	27	L2	22	22	28	28	32	36
D5	15	15	20	20	27	27	L3	34	34	38	44	51.6	53.1
D6	12	12	16	16	22	22	L4	12	12	17	17	20	22
EE	M5	M5	M5	M5	G1/8"	G1/8"	L5	10	10	15	15	18	20
EW	8	8	12	12	16	16	SW2	-	-	5	5	7	9
AM	12	12	16	16	20	22	WH	16	16	22	22	24	26
KK	M4	M4	M6	M6	M8	M10X1.25	XC	64	64	75	82	95	104

GRAPHIC SIGN

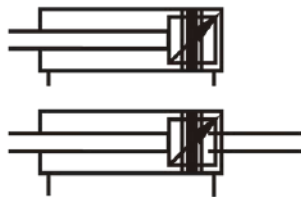

ORDERING CODE

Series Code (SDA)	Cylinder Bore (20)	Stroke (30)	Magnet Code (S)	Cog Type (B)
SDA : Double Action Type	12mm-100mm		Blank : without Magnet S : Attach Magnet	Blank :Inner Thread B : Outer Thread N : No Thread

INTERNAL STRUCTURE

1 Back Cover	7 Anti - Crash Cushion
2 Type C Buckle Ring	8 Barrel
3 O-Ring	9 Front Cover Seal Ring
4 Anti - Crash Cushion	10 Front Cover
5 Piston	11 Piston Rod
6 Piston O-Ring	12 Piston Rod Nut

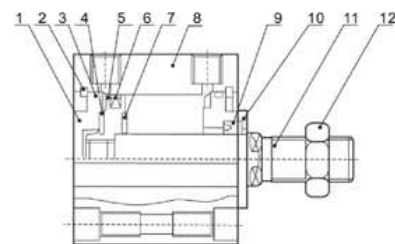

SPECIFICATION

Bore (mm)	12	16	20	25	32	40	50	63	80	100
Motion Pattern	Double Action, Single Acting Extrusion type Single Acting Drawing - in Type									
Working Medium	Air									
Operating Voltage Range Double Action						0.1~0.9MPa				
Operating Voltage Range Single Action						0.2~0.9MPa				
Ensured Pressure Resistance						1.35Mpa				
Operating Temperature Range						-5~70oC				
Operating Speed Range Double Action	300~500mm/s			300~350mm/s			300~250mm/s			
Operating Speed Range Single Action						100~500mm/s				
Buffer Type	Fixed Type Buffer									
Port Size	M5 X 0.5			G1/8"		G1/4"		G3/8"		

STROKE

Bore		12	16	20	25	32	40	50	63	80	100		
Double Action	Not Attached Magnet	5~60mm Every 5mm is Grouped as one grade		5~85mm Every 5mm is Grouped as one grade		5~90mm Every 5mm is Grouped as one grade		100~110mm Every 5mm is Grouped as one grade		5~90mm Every 5mm is Grouped as one grade		100~130mm Every 5mm is Grouped as one grade	
	Attached Magnet	5~60mm Every 5mm is Grouped as one grade		5~85mm Every 5mm is Grouped as one grade		5~90mm Every 5mm is Grouped as one grade		100mm		5~90mm Every 5mm is Grouped as one grade		100~120mm Every 5mm is Grouped as one grade	
Single Action	Not Attached Magnet			5~60mm Every 5mm is Grouped as one grade				5~30mm Every 5mm is Grouped as one grade				---	
	Attached Magnet			5~60mm Every 5mm is Grouped as one grade				5~30mm Every 5mm is Grouped as one grade				---	
Max Stroke		50 mm		100 mm		120 mm		130 mm					

OVERALL DIMENSION

12 ~ 16

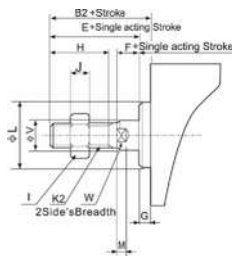

20 ~ 100

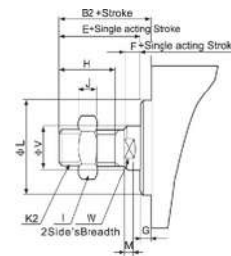

BORE / SYMBOL

Bore	B2	E	F	G	H	I	J	K2	L	M	V	W
12	17	16	4	1	10	8	4	M5 X 0.80	10.2	2.8	6	5
16	17.5	16	4	1.5	10	8	4	M5 X 0.80	11	2.8	6	5
20	20.5	19	4	1.5	13	10	5	M6 X 1.00	16	2.8	8	6
25	23	21	4	2	15	12	6	M10 X 1.50	17	2.8	10	8
32	25	22	4	3	15	17	6	M14 X 1.50	22	2.8	12	10
40	35	32	4	3	25	19	8	M18 X 1.50	28	2.8	16	14
50	37	33	5	4	25	27	11	M18 X 1.50	38	2.8	20	17
63	37	33	5	4	25	27	11	M22 X 1.50	40	2.8	20	17
80	44	39	6	5	30	32	13	M22 X 1.50	45	4	26	22
100	50	45	7	5	35	36	13	M26 X 2.00	55	4	32	27

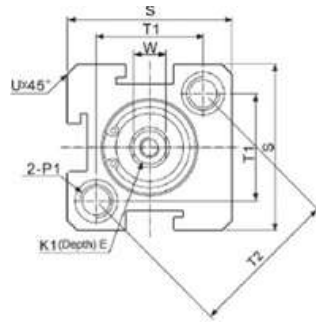
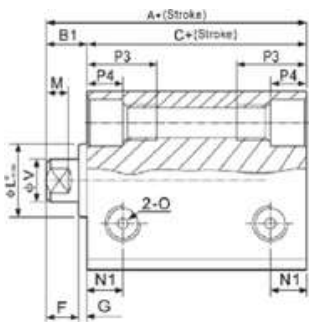

12 ~ 16

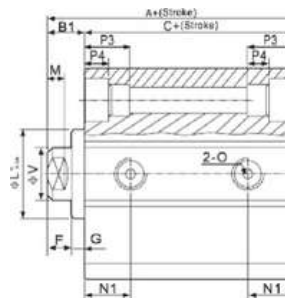
OVERALL DIMENSIONS

20 ~ 100

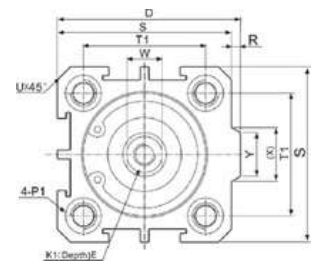

DIMENSIONS SHEET

Bore	N3	O	P1	P3	P4	R	S	T1	T2	U	V	W	X	Y
12	6	M5 X 0.8	Double Side : 6.5/Thread:M5x0.8/Through Ports : 4.2	12	4.5	-	25	16.2	23	1.6	6	5	-	-
16	6.5	M5 X 0.8	Double Side : 6.5/Thread:M5x0.8/Through Ports : 4.2	12	4.5	-	29	19.8	28	1.6	6	5	-	-
20	-	M5 X 0.8	Double Side : 6.5/Thread:M5x0.8/Through Ports : 4.2	14	4.5	2	34	24	-	2.1	8	6	11.3	10
25	-	M5 X 0.8	Double Side : 8.2/Thread:M6x1/Through Ports : 4.6	15	5.5	2	40	28	-	3.1	10	8	12	10
32	-	G1/8"	Double Side : 8.2/Thread:M6x1/Through Ports : 4.6	16	5.5	6	44	34	-	2.15	12	10	18.3	15
40	-	G1/8"	Double Side : 10/Thread:M6x1.25/Through Ports : 6.5	20	7.5	6.5	52	40	-	2.25	16	14	21.3	16
50	-	G1/4"	Double Side : 11/Thread:M8x1.25/Through Ports : 6.5	25	8.5	9.5	62	48	-	4.15	20	17	30	20
63	-	G1/4"	Double Side : 11/Thread:M8x1.25/Through Ports : 6.5	25	8.5	9.5	75	60	-	3.15	20	17	28.7	20
80	-	G3/8"	Double Side : 14/Thread:M12x1.75/Through Ports : 9.2	25	10.5	10	94	74	-	3.65	25	22	36	26
100	-	G3/8"	Double Side : 17.5/Thread:M14x2/Through Ports : 11.3	30	13	10	114	90	-	3.65	32	27	35	26

Bore	A	B1	C	A	B1	C	D	F	G	K1	L	M	N1
12	22	5	17	32	5	27	-	4	1	M3 X 0.50	10.2	2.8	6.3
16	24	5.5	18.5	34	5.5	28.5	-	4	1.5	M3 X 0.50	11	2.8	7.3
20	25	5.5	19.5	35	5.5	29.5	36	4	1.5	M4 X 0.70	15	2.8	7.5
25	27	6	21	37	6	31	42	4	2	M5 X 0.80	17	2.8	8
32	31.5	7	24.5	41.5	7	34.5	50	4	3	M6 X 1.00	22	2.8	9
40	33	7	28	43	7	36	58.5	4	3	M8 X 1.250	28	2.8	10
50	37	9	28	47	9	38	71.5	5	4	M10 X 1.50	38	2.8	10.5
63	41	9	32	51	9	42	84.5	5	4	M10 X 1.50	40	2.8	11.8
80	52	11	41	62	11	51	104	6	5	M14 X 1.50	45	4	14.5
100	63	12	51	73	12	61	124	7	5	M18 X 1.50	55	4	20.5

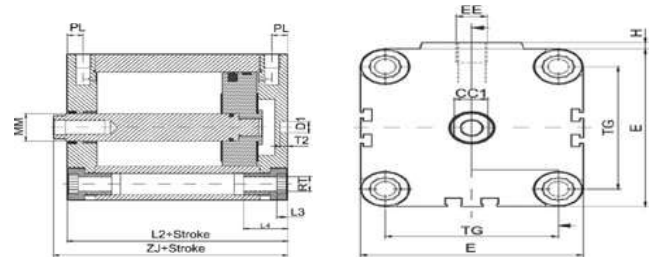

ADVU

INTERNAL STRUCTURE

ORDERING CODE

Series Code (ADVU)	Cylinder Bore (50)	Stroke (80)	Cog Type (A)	Magnet Code (A)	Plunger Code (S2)
ADVU : Double Action Type AEVUZ : Single-drive type AEVUD : Double - Half Double Action Type	16mm - 100mm	Normal Type 16-25 : 1-200mm 32-63 : 1-3300mm 80-100 : 1-400mm Single Action 12 : 1-10mm 16-100 : 1-25mm	Blank : Inner Thread A : Outer Thread	Blank : With Out Magnet A : Attach Magnet	Blank : Single end Connecting Rod S2 : Both ends Connecting Rod

DIMENSIONS SHEET

Bore	D1	E	EE	H	L2	L3	L4	MM	PL	RT	T2	TG	ZJ	CC1
16	6	29	M5	1	38	4	18.5	8	8	M4	4	18	41	6
20	6	35.5	M5	1.5	38	4	18.5	10	8	M5	4	22	41	8
25	6	39.5	M5	1.5	39.5	4	18.5	10	8	M5	4	26	43.5	8
32	6	49.5	G1/8	2	44.5	5	22	12	8	M6	4	32	49.5	10
40	6	59.5	G1/8	2.5	45.5	5	22	12	8	M6	4	42	51	10
50	6	68	G1/8	2.8	46.5	5	22	16	8	M8	4	50	53	14
63	8	86	G1/8	4	50	6	26	16	8	M10	4	62	56	14
80	8	106	G1/8	4	56	6	26	20	8.5	M10	4	82	62	17
100	8	128	G1/4	5	66.5	8	26	35	10.5	M10	4	103	76.5	24

SPECIFICATION

Bore (mm)	16	20	25	32	40	50	63	80	100
Action	Double Acting, Single & Double Rod								
Working Medium	Air								
Ensured Pressure Resistance	1.5MPa								
Operating Pressure Range ADVU - - P-A	0.12~1.0mpa	0.13~1.0mpa			0.08~1.0MPa			0.08~1.0MPa	
Operating Pressure Range ADVU - - P-A-S2	0.1~1.0mpa	0.12~1.0mpa			0.1~1.0MPa			0.1~1.0MPa	
Ambient & Fluid Temperature	-20~80 (No Freezing)								
Port Size	M5			G1/8"			G1/4"		
Piston Female Thread	M5	M5	M6	M6	M8	M10	M12	M12	
Piston Male Thread	M8	M10 X 1.25	M12 X 1.25	M16 X 1.5	M20 X 1.5				
Cushion	Rubber Bumper								

SC / SU CYLINDER ACCESSORIES

CA MALE CLAVES

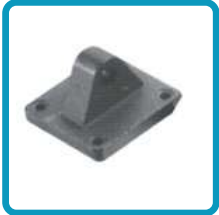

CB + PIN FEMALE CLAVES MOUNTING



FA / FB FRONT & REAR FLANGE



TC CENTER TRUNNION

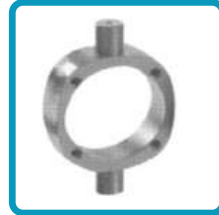

LB LEG BRACKET



SC / DNC / SU / MAL / MS CYLINDER ACCESSORIES

FISH-EYE ADAPTER



FLOATING JOINT



AXES ADAPTER - Y



I-PIN



Y+PIN WITH CLIP



DNC CYLINDER ACCESSORIES

CA MALE CLAVES



CB + PIN FEMALE CLAVES MOUNTING



FA / FB FRONT & REAR FLANGE



LB LEG BRACKET



TC CENTER TRUNNION

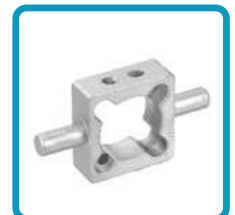

MAGNETIC SENSOR SWITCHCG

XC-03R / MAL & MS



XC-21R / SC & SU



XC-11R / SDA



XC-31R / DNC

